

RESIDENTIAL GAS WATER HEATERS

Lochinvar's Ultra Low NOx Power Direct Vent residential gas models are available in 40 and 50 gallon capacities, featuring an innovative burner system with Power Direct Vent to comply with South Air Quality Management District and other air quality programs requiring less than 10 ng/j of NOx emissions. The 0.70 Energy Factor qualifies for ENERGY STAR.

ULTRA LOW NOX POWER VENT GAS MODELS

STANDARD FEATURES

ENERGY STAR® - The Ultra Low NOx Power Direct Vent water heaters meet the ENERGY STAR requirement and are eligible for most utility rebate programs.

CODE COMPLIANCE - Complies with the Federal Energy Conservation Standards effective April 16, 2015, in accordance with the Energy Policy and Conservation Act, (EPCA) as amended.

POWER DIRECT VENT SYSTEM - This 2-pipe closed combustion system utilizes a vent to exhaust the by products of combustion and a separate air intake to provide fresh combustion air. Vents through a sidewall or through the roof using 2", 3" or 4" PVC, CPVC or Polypropylene vent material. The design is Flammable Vapor Ignition Resistant.

GLASS-LINED STEEL TANK - The durable glass lining is fused to the steel tank at 1,600°F to assure lasting protection against rust and corrosion while providing clear, clean hot water. Standard 150 PSI working pressure.

ELECTRONIC GAS CONTROL - The gas valve features electronic ignition control logic for precise temperature control and an LED status indicator for simplified service diagnostics.

NON-CFC FOAM INSULATION - A uniform coverage of thick closed-cell foam insulation minimizes standby heat loss, maximizes heat retention and delivers a high Uniform Energy Factor.

BRASS DRAIN VALVE - An enhanced ball valve design for effective drainage and positive shut-off.

6-YEAR LIMITED TANK & PARTS WARRANTY* – See warranty sheet for details.

10-YEAR EXTENDED WARRANTY – Available for residential applications only

* 1-year limited tank & parts warranty when installed in a commercial application.



Lochinvar®
HIGH EFFICIENCY BOILERS & WATER HEATERS

DIMENSIONS AND SPECIFICATIONS

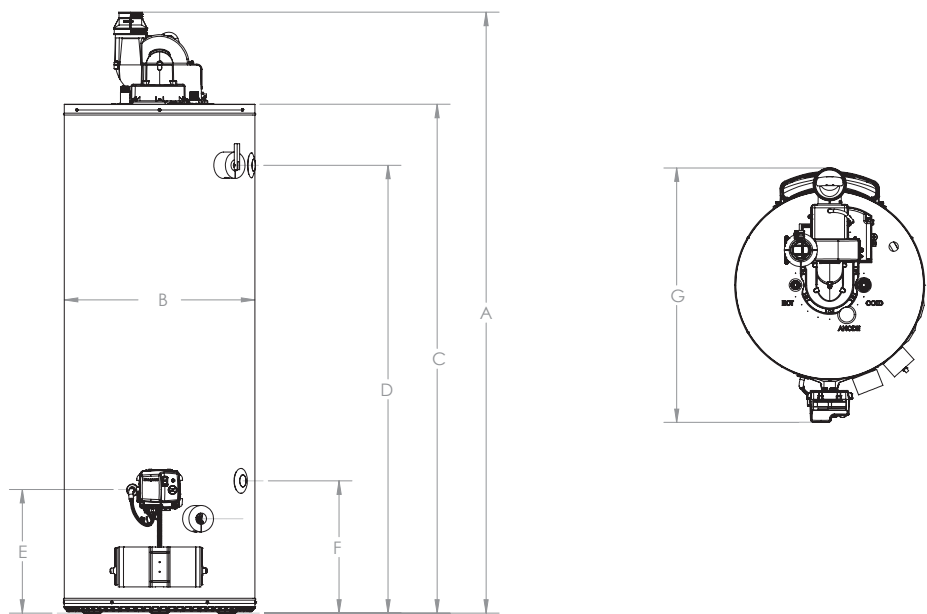

Model Number	Nominal Gal. Cap.	Rated Storage Cap.	Nat. Gas Btu/Hr Input	UEF	1st Hr. Rating	GPH @ 90°F Rise	A	B	C	D	E	F	Gas Conn.	Water Conn.	Vent & Intake Size	Ship. Wt.
UPDN04040	40	38	40,000	0.70	75	41	58-1-4"	22"	49-3/4"	42-1/2"	13-1/4"	15-1/4"	1/2"	3/4"	2", 3" or 4"	174
UPDN05040	50	48	40,000	0.70	75	43	67-1/2"	22"	58-3/4"	51-3/4"	13-1/4"	15-1/4"	1/2"	3/4"	2", 3" or 4"	192

Notes: Operates on Natural Gas only.
 Top inlet and outlet are on 8" centerlines.
 All models rated for installation at altitudes to 5,400 feet. Use high altitude kit for elevations to 10,100 feet.
 Use the High Ambient kit for installations where the ambient temperature is between 110°F and 140°F.

Vent Kits	Part Number
2" Concentric Vent Kit	100112869
3" Concentric Vent Kit	100111100
High Altitude Kit *	100153232
High Ambient Air Kit **	100308933

* Vent Kit includes: Coupling, Termination elbows and Sound Suppressor
 ** High Ambient Air Kit must be installed with CPVC

FOR EASE IN ORDERING BY MODEL NUMBER				
R	U	PD	050	40
RESIDENTIAL	ULTRA LOW NOX	POWER DIRECT VENT	GALLON CAPACITY	BTU/HR INPUT

This heater is a 40,000 Btu/hr
 Power Direct Vent natural gas water heater with a
 50 gallon storage capacity and side tappings.

For technical information call 800-722-2101. Lochinvar, LLC reserves the right to make product changes or improvements without prior notice.



Lochinvar, LLC
 300 Maddox Simpson Parkway
 Lebanon, Tennessee 37090
 P: 615.889.8900 / F: 615.547.1000
[f](#) [in](#) [u](#) [o](#) [t](#) [Lochinvar.com](#)



RUPD-01 (NEW)

Website update 7/24-Printed in U.S.A.