

COMMERCIAL WATER HEATERS

The Ultra Low NOx Charger gas fired, tank type water heaters are designed to provide ease of installation, low stand-by loss and years of trouble free service. Complies with SCAQMD rule 1146.2 for less than 14 ng/j or 20 ppm. Chargers are ideally suited for apartments, schools, food service and many other commercial and industrial applications with up to 180°F service requirements.

ULTRA LOW NOX CHARGER GAS MODELS

STANDARD FEATURES

QUALITY DESIGN – The Ultra Low NOx Charger features a multi-flue design for increased efficiency and fast heat transfer. It is designed with three sets of water circulation tappings. Water connections on the top, the front and the back provide ultimate flexibility, especially in retrofit applications. And all models are combustible floor approved.

FAN-ASSISTED COMBUSTION - Ultra Low NOx Operation uses a blower built into the Ultra Low NOx burner to deliver precise combustion. Even with the advanced combustion design, the Charger is a Category I appliance using standard double wall “B” vent.

GLASS-LINED STEEL TANK - The durable glass lining is fused to the steel tank at 1,600°F to assure lasting protection against rust and corrosion while providing clear, clean hot water. 300 PSI test pressure; 150 PSI working pressure. Available in standard construction or ASME construction over 200,000 Btu/hr input.

NON-CFC FOAM INSULATION - A uniform coverage of thick closed-cell foam insulation minimizes standby heat loss, maximizes heat retention and delivers a high uniform Energy Factor.

TANK SAVER ANODE - Large diameter, high capacity anodes inhibit corrosion of the tank interior for long, trouble-free service.

ASME TEMPERATURE & PRESSURE RELIEF VALVE - Factory installed for optimum safety.

BRASS DRAIN VALVE - An enhanced ball valve design for effective drainage and positive shut-off.

3-YEAR LIMITED TANK WARRANTY / 1-YEAR PARTS WARRANTY –
See warranty sheet for details.



DIMENSIONS & SPECIFICATIONS

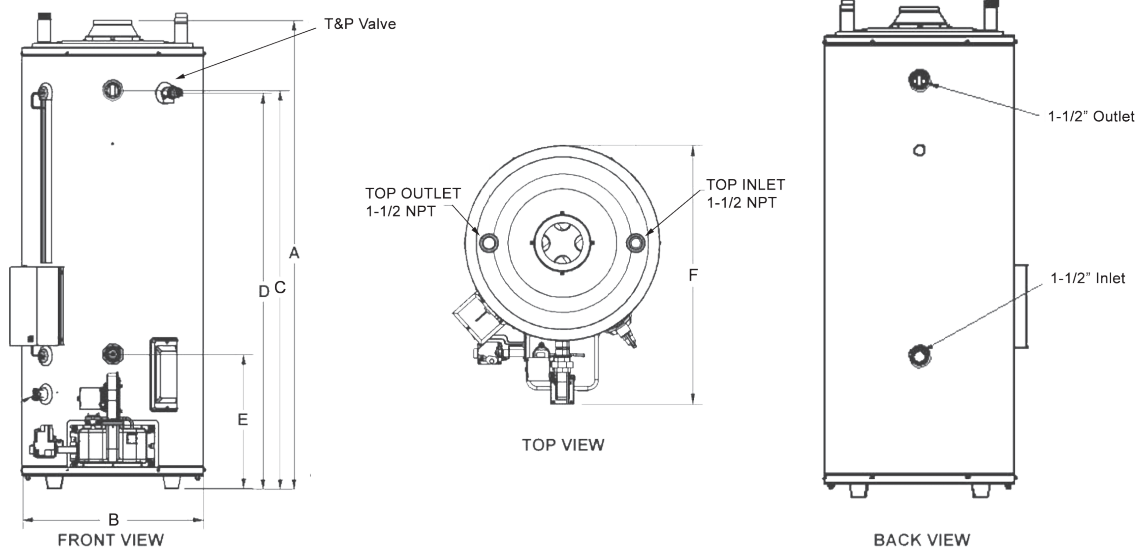

| ULTRA LOW NOX CHARGER GAS MODELS | | | | DIMENSIONS AND SPECIFICATIONS | | | | | | | | | | |
|----------------------------------|--------------|------------------|------------------|-------------------------------|---------|-----|---------|---------|-----|-----------|----------|------------|-----------------|------------------------|
| Model Number | Btu/hr Input | Capacity Gallons | GPH @ 100°F Rise | A | B | C | D | E | F | Vent Size | Gas Conn | Water Conn | Shipping Weight | Shipping Weight (ASME) |
| CLN120 080 | 120,000 | 81 | 115 | 63-3/4" | 27-3/4" | 53" | 52-3/4" | 20-3/4" | 37" | 6" | 3/4" | 1-1/2" | 605 | - |
| CLN154 080 | 154,000 | 81 | 148 | 63-3/4" | 27-3/4" | 53" | 52-3/4" | 20-3/4" | 37" | 6" | 3/4" | 1-1/2" | 605 | - |
| CLN180 080 | 180,000 | 81 | 173 | 63-3/4" | 27-3/4" | 53" | 52-3/4" | 20-3/4" | 37" | 6" | 3/4" | 1-1/2" | 605 | - |
| CLN199 100 | 199,000 | 100 | 191 | 71-3/4" | 27-3/4" | 61" | 60-3/4" | 20-1/2" | 37" | 6" | 3/4" | 1-1/2" | 665 | - |
| CLN250 100(A) | 250,000 | 100 | 240 | 71-3/4" | 27-3/4" | 61" | 60-3/4" | 20-1/2" | 37" | 6" | 3/4" | 1-1/2" | 665 | 715 |
| CLN275 100(A) | 275,000 | 100 | 264 | 71-3/4" | 27-3/4" | 61" | 60-3/4" | 20-1/2" | 37" | 6" | 3/4" | 1-1/2" | 665 | 715 |
| CLN310 085(A) | 310,000 | 86 | 298 | 71-3/4" | 27-3/4" | 61" | 60-3/4" | 20-1/2" | 37" | 6" | 3/4" | 1-1/2" | 740 | 790 |
| CLN366 085(A) | 366,000 | 86 | 352 | 71-3/4" | 27-3/4" | 61" | 60-3/4" | 20-1/2" | 37" | 6" | 3/4" | 1-1/2" | 740 | 790 |
| CLN400 085(A) | 390,000 | 86 | 375 | 71-3/4" | 27-3/4" | 61" | 60-3/4" | 20-1/2" | 37" | 6" | 3/4" | 1-1/2" | 740 | 790 |

A = ASME Construction
See the installation manual for dimensional information on Top and Back Tappings
Rated up to 10,000 Feet Altitude.

OPTIONAL EQUIPMENT

UL Sanitation

FOR EASE IN ORDERING
BY MODEL NUMBER

| CL | N | 120 | 080 |
|-----------------|-------------|--------------|-----------------|
| Charger Low NOx | Natural Gas | Btu/hr Input | Gallon Capacity |

This is a natural gas Charger Ultra Low NOx water heater. It has standard construction, 120,000 Btu/hr, and 80 gallon storage capacity.

For technical information call 800-722-2101. Lochinvar, LLC reserves the right to make product changes or improvements without prior notice.



Lochinvar, LLC
300 Maddox Simpson Parkway
Lebanon, Tennessee 37090
P: 615.889.8900 / F: 615.547.1000
Lochinvar.com

